

STILL SPIRITS

EASY INLINE FILTER

SPECIFICALLY DESIGNED
FOR PURIFICATION
OF ALCOHOL.



CARBON CARTRIDGE TECHNOLOGY

The Easy Inline Filter Carbon Cartridge is constructed from a specially formulated blend of carbons that have been selected with pore sizes ideal for removing impurities in distilled spirit, or unwanted chemicals from water. It is fast, clean and easy to use.

PURIFICATION

Activated carbon is prepared in a manner which causes the carbon crystals to become porous and develop a very large surface area. One gram of activated carbon may have 500-1500 m² of internal surface area. This large surface area and the many internal pores in the carbon are able to adsorb many different chemical compounds including those which cause unwanted flavours in your spirit. The absorption process is very complex and depends on concentrations, molecular weight etc. In the case of alcoholic spirit, the process works best if the alcohol concentration is 50% or less. This is why we recommend adjusting the alcohol level before purification.

OPERATION

Your Easy Inline Filter comes assembled ready to use. One cartridge is suitable for one batch of spirit from a 25 L (6.6 US Gal) still (about 8 L (2.1 US Gal) of 50% spirit). A fresh cartridge should be used for each batch.

- 1 Soak the Easy Inline Filter Carbon Cartridge in a glass of clean water until the cartridge is fully submerged and air bubbles have stopped escaping from it. This is necessary to remove mineral salts from the carbon and flush out any carbon dust. You should do this for every new cartridge.
- 2 Connect the filter to the tap on the reservoir (not supplied) with a short length of clear PVC tube. The tube should not be more than 100 mm (3.9") long.

- 3 For each new filter cartridge, run 3 L (0.8 US Gal) of water through the system to prepare the filter for alcohol filtration. Close the tap and add 3 L (0.8 US Gal) of water to the reservoir, then open the tap and allow the water to pass through.
- 4 Close the tap and add your spirit to the reservoir.
- 5 Adjust the alcohol level to under 50% with clean water. Check this with a spirit hydrometer or alcoholmeter.
- 6 Open the tap and allow the spirit to pass through the filter into a collecting pail.

REPLACING THE CARTRIDGE

Foam washers are reusable for up to 3 times but should be replaced if they flatten with use and no longer recover to normal thickness. It is a simple matter to replace the used cartridge.

Components are assembled in the following order on the spindle:

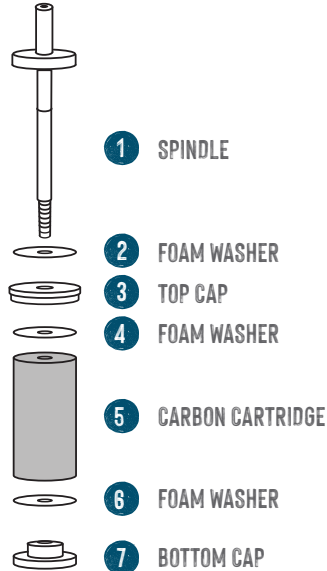

Screw up by hand, taking care not to over tighten. Press the outer plastic housing onto the top cap.